

Túnel CASTILLO
CASTLE Tunnel
Tunnel CHÂTEAU
Túnel CASTELO



EN 1176.







PM802:

Madera y madera laminada tratada en autoclave clase IV, polietileno, y acero pintado al polvo.

Autoclave treated class IV wood and laminated wood, polyethylene and powder coated steel.

Bois et bois lamellé-collé traité en autoclave classe IV, polyéthylène et acier peint à la poudre.

Madeira e madeira laminada tratada em autoclave classe IV, polietileno e aço pintado al pó.

-  1-12
-  0,11 m.
-  103 Kg.
-  2,23 x 1,8 x 1 m.
-  5,22 x 4,24 m.
-  20,2 m².

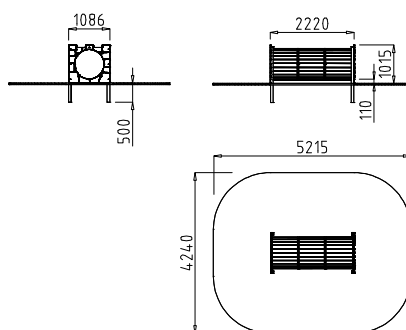

E: 1/200